

## OF-CR2.0 Small Conference Room: occupancy sensing

Control Needs	Solution	Application Description
Automatically turn lights ON/OFF based on occupancy	Corner-mounted passive infrared occupancy sensor (CX series)	Space use: Meetings of small groups, group projects Dimensions: 10' x 12' Ceiling height: 10' Windows: Windows along one wall providing view to exterior
Manual ON/Manual override OFF	Wall switches	Window blinds: Horizontal blinds
Bi-level switching	Tandem-wired ballasts and wall switches	
Occupancy-based control of HVAC system	Isolated relay on occupancy sensor	

### Lighting

Pendant mounted 4' luminaires, using 3 T8 lamps and 2-lamp, tandem wired, 277 volt electronic ballasts. Recessed compact fluorescent wallwash luminaires highlighting whiteboard.

### Design Considerations

The CX-100 PIR occupancy sensor is used to automatically turn lights off when the conference room is unoccupied and turn lights on upon occupancy. The sensor is mounted in the corner, to prevent a view out the doorway that might otherwise result in false activations. Two wall switches are used for bi-level switching. A third wall switch is used for switching wallwashers.

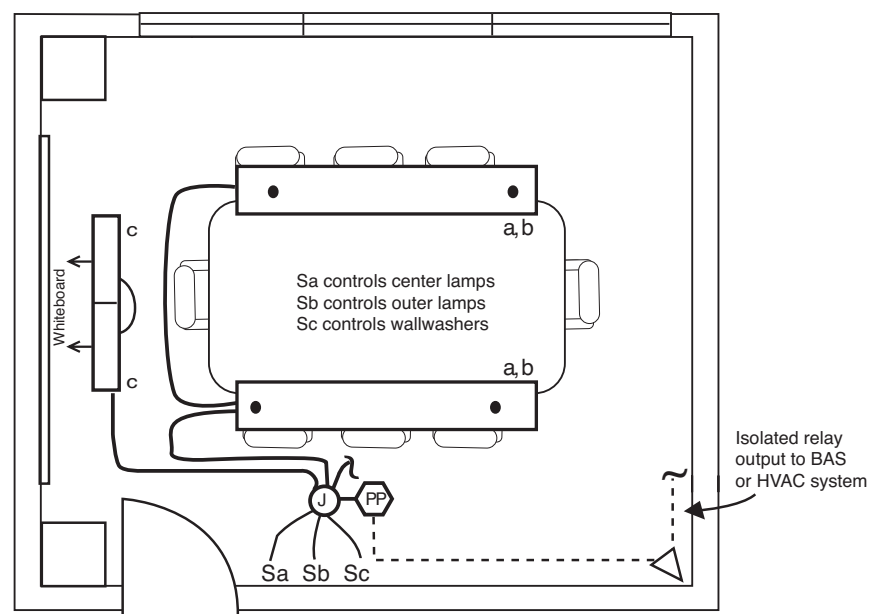

LEGEND	
	CX-100 PIR occupancy sensor
	B277E-P power pack
	Junction box
	Wall switch
	Low voltage wiring
	Line voltage wiring
	Wallwash luminaire
	Pendant luminaire



## OF-CR2.0 Installation Notes

1. Mount CX-100 occupancy sensor at same height as luminaire so that sensor view is not blocked.
2. Mount CX-100 in corner and aim at opposing corner to provide a full view of the room but not out the door.
3. CX-100 is shipped with a factory preset time delay of 18 minutes, the recommended minimum for conference rooms and with sensitivity setting at maximum. Refer to installation instructions if adjustments are necessary.
4. Use a minimum of 22 gauge wire for low voltage wiring. See Technical Bulletin TB-124 on Voltage Loss at [www.wattstopper.com](http://www.wattstopper.com).
5. CX-100 sensors isolated relay can provide status information to the BAS and/or control HVAC loads.

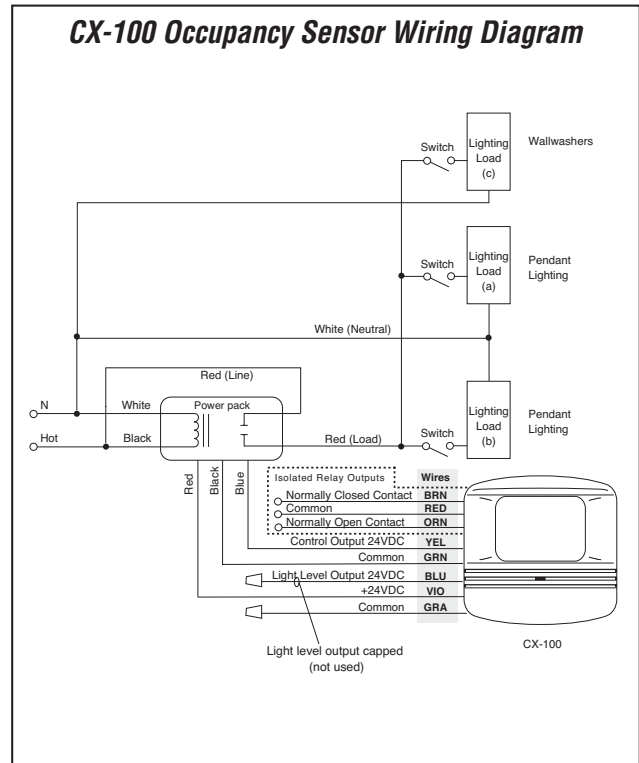
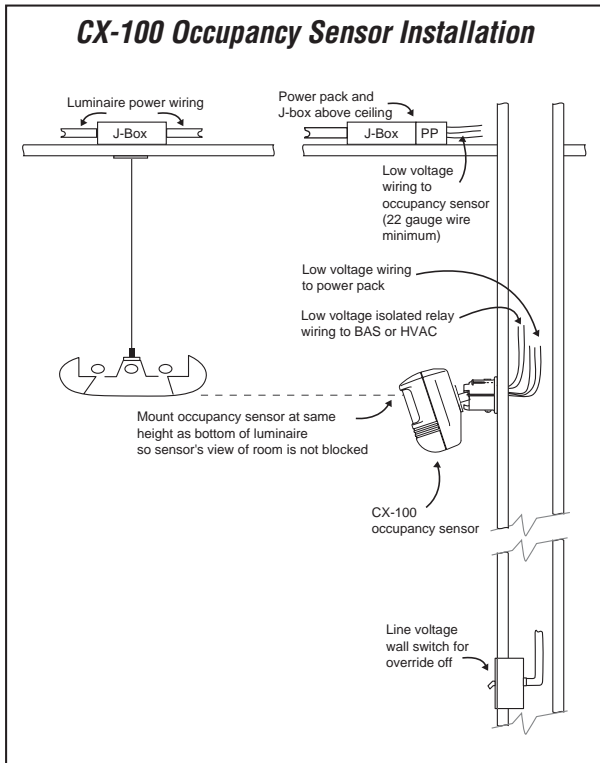

## Equipment Schedule

Catalog No.	Qty	Description
CX-100	1	Passive infrared occupancy sensor, isolated relay, wide angle lens
B277E-P	1	Power pack, 277 VAC, 60 Hz
AC1 Series	3	Wall switch, Pass & Seymour/legrand, AC1 series, single pole
SP Series	1	Wall plate, Pass & Seymour/legrand, SP series, 3-gang